

# AUGUSTA LM6-G2 TIGER DATA SHEET



## Product information

A LED Augusta is a powerful floodlight for outdoor and indoor use with asymmetrical light distribution. Suitable for professional lighting of large areas such as sports facilities, harbor areas, ships, container areas, etc.

Augusta is manufactured in die-cast LM6 seawater-resistant aluminum with Tiger paint, which is among the market's most resistant paint types, which ensures minimal maintenance and very high corrosion protection. Augusta is also equipped with the latest optics, which ensures very low glare.

Augusta has silicone gaskets, screws in A4 corrosion-proof and mounting brackets in AISI316L stainless steel. It is linkable with up to 5 x 2.5m2 cable.

The driver is from Meanwell's top-series HLG and the diodes are from Japanese Nichia.



## Operation and Maintenance Tips

- \* Turn power off before inspection, installation or removal
- \* The product should be kept free from contamination.
- \* All install and uninstall shall be done by a certified electrician
- \* Do not operate luminaire with damaged part.
- \* Do not cover the luminaire when installed.
- \* Exceeding maximum ratings for operating temperature and input voltage will reduce expected life time or destroy the product.

## Energy Class

This product contains a light source in the energy efficiency class: **C**

## Replaceability



## Features

- \* Marine grade salty spray protection
- \* Asymmetrical optic system
- \* Easy replacement of LED and driver
- \* Safety class I, flicker free
- \* L96 - 100.000 at 10°C
- \* Spare parts available upon request
- \*

## General information

Light source type	LED
Protection class IEC	Class I
Optical cover type	Tempered glass
Driver included	Yes
Glow-wire test	Temperature 960°C
Driver input voltage	100-305Vac
Power Factor	> 0.97
Working temperature range	-40°C ~ +50°C
Housing material	Aluminum die cast
Housing color	Black
Fixation material	Stainless steel
Effective projected area	0.16 m2
Ingress protection code	IP66
Mech.impact protection code	IK09
Risk group (EN 62471:2008)	RG1
SDCM	5

## Product pictures

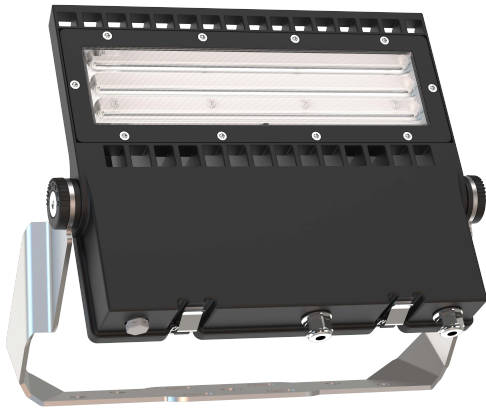

## Dimension drawings

75W/150W

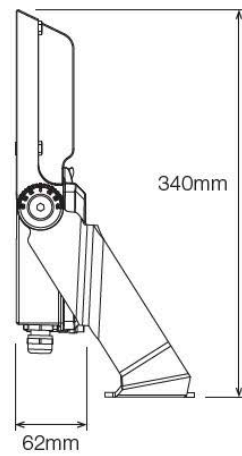
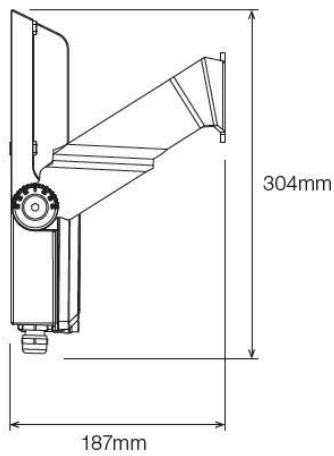
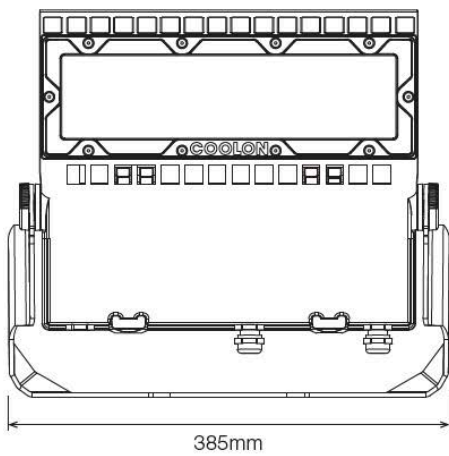

240W

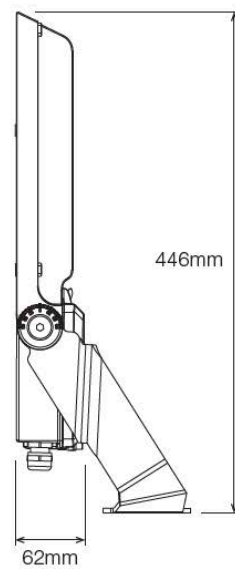
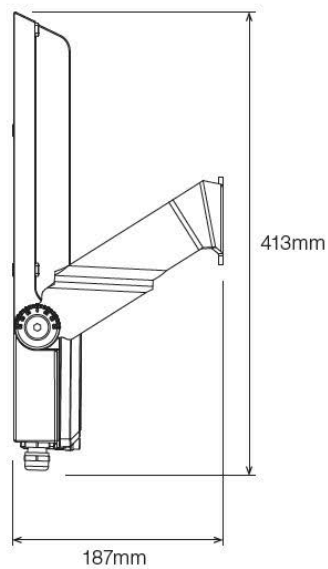
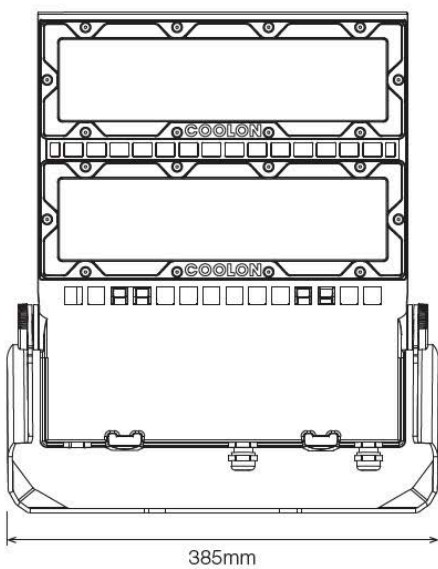

## Bracket

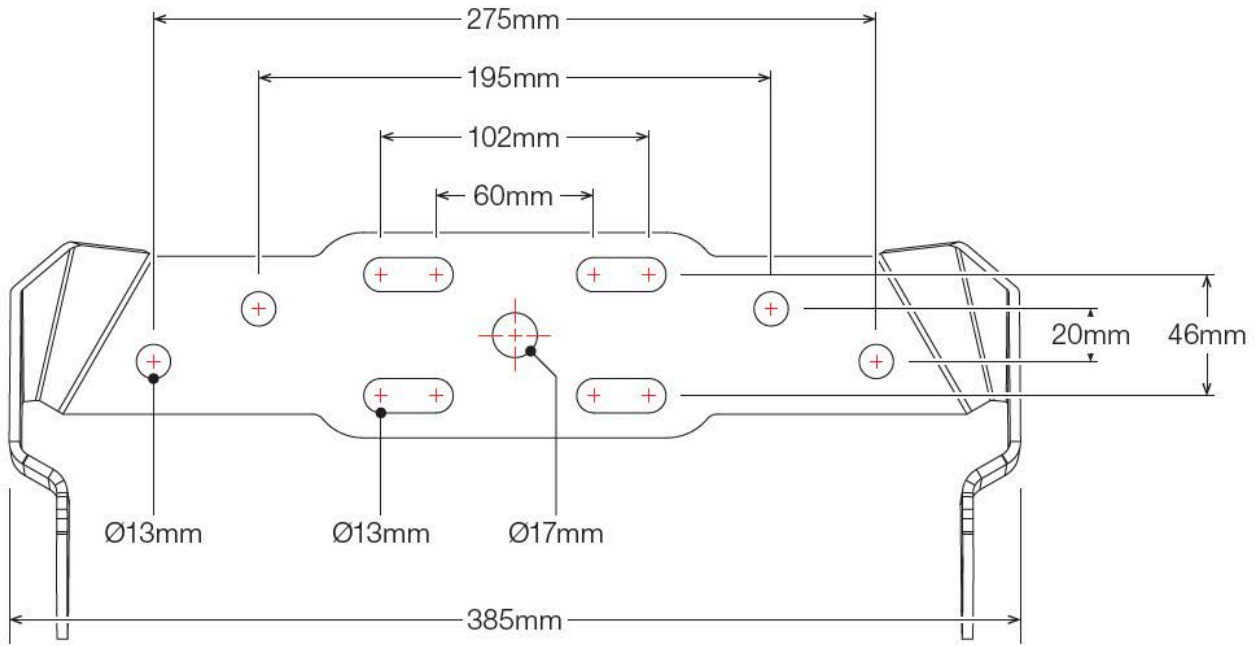

## Light distribution

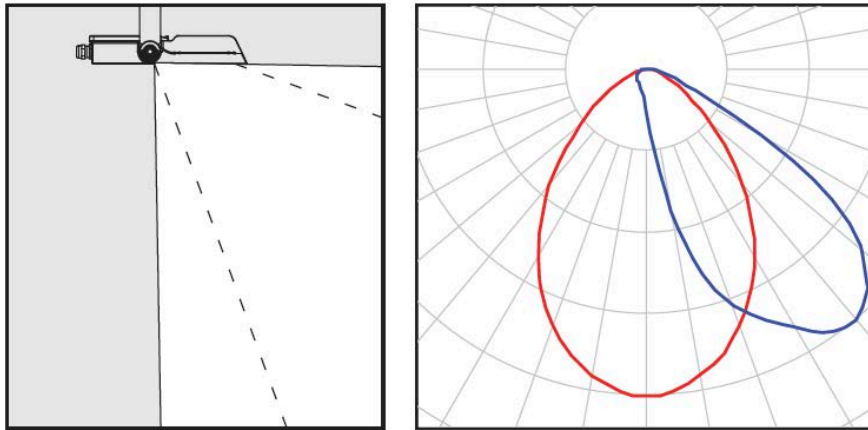

Polar Distribution

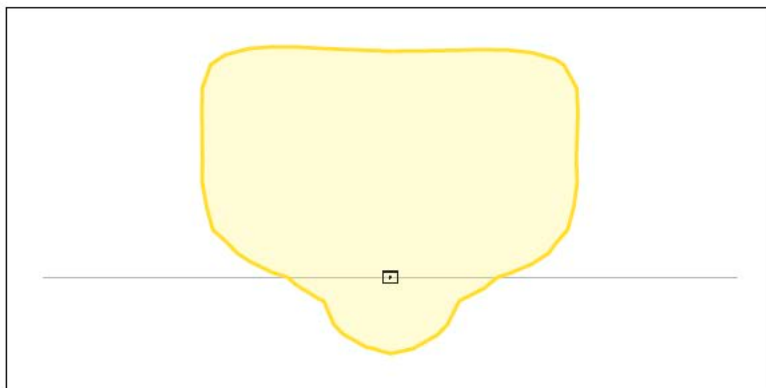

## Wiring diagram

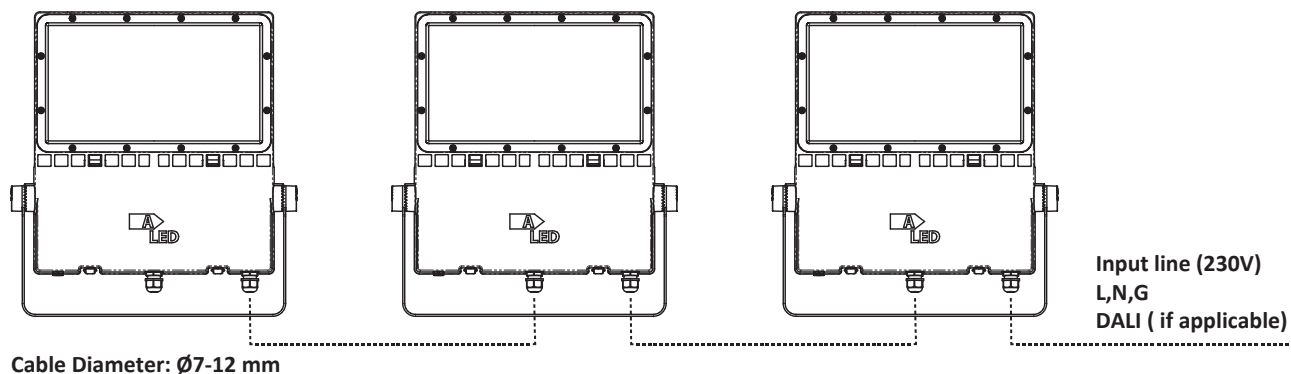



## Max load on breaker

Type of electrical protection installation		Maximum number of luminaires to install			
		Augusta 75W	Augusta 150W	Augusta 240W	Augusta 300W
MCB16A	B TYPE	5	3	4	2
	C TYPE	8	6	6	4
Inrush Current (230VAC) / Leak current		50A,350 $\mu$ s / 0,3mA	65A,550 $\mu$ s / 0,32mA	60A,510 $\mu$ s / 0,34mA	110A,50 $\mu$ s / 0,34mA
Luminaire Surge Protection		Line-Earth 6KV, Line-Line 4KV	Line-Earth 6KV, Line-Line 4KV	Line-Earth 6KV, Line-Line 4KV	Line-Earth 10KV, Line-Line 6KV



Additional surge protective device (SPD) is recommended to use if necessary !

# Specifications

COLOR CODE	EAN	LUMEN	WATT		EPA m2	Ta Max.°C Outdoor	Ta Max.°C Indoor	Ta Min.°C	BEAM ANGLE Asymmetric	
840	5701025001502	9750	75	✓	0.16	45	35	-40	50x88	6.2 Kg
	5701025003506	19500	150	✓	0.16	45	35	-40	50x88	6.3 Kg
	5701025005500	31200	240	✓	0.16	45	35	-40	50x88	8.2 Kg

\* Due to the special conditions of the manufacturing processes of LED, the typical data of technical parameters can only reflect statistical figures and do not necessarily correspond to the actual parameters of each single product which could differ from the typical value. A max ±7% tolerance is deemed to be acceptable in any case.



**Tc max. of PCBA = 95°C**  
**Performance ambient temperature +10°C**  
**Max designed wind speed: 52m/S**

## Lifetime and driver failure rate

